

STAFF STORAGE CABINET(S)  
(BROOMS, MOPS, VACUUM,  
TOILET GOODS, PAPER  
GOODS, CLEANING  
SUPPLIES)

???

EXISTING PLAY  
STRUCTURE. REASSEMBLE  
IN CURRENT LOCATION  
AFTER FLOORING AND  
HEATING INSTALLATIONS

LOFT ABOVE WILL BE USED  
FOR A PLACE FOR PRIVACY  
AND BOOK SHELVES WILL  
BE PLACED BELOW TO  
SUPPLEMENT THE  
READING CENTER

PROVIDE NEW  
EGRESS WINDOW.  
DASHED LINES  
SHOW A STEP AT  
THE WINDOW AND  
THE NEW OUTLINE  
OF A PLATFORM.

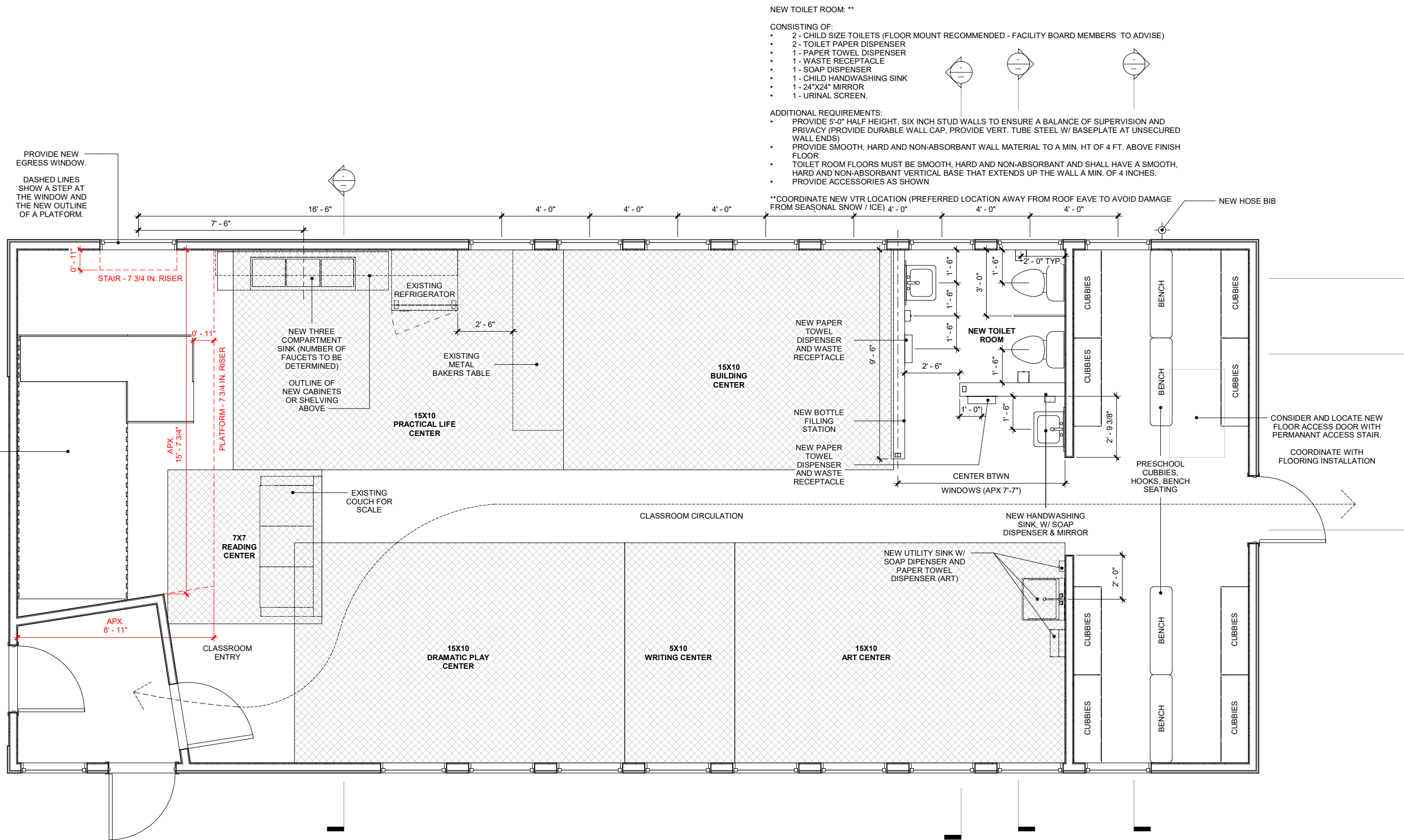

NEW TOILET ROOM: \*\*

CONSISTING OF:

- 2 - CHILD SIZE TOILETS (FLOOR MOUNT RECOMMENDED - FACILITY BOARD MEMBERS TO ADVISE)
- 2 - TOILET PAPER DISPENSER
- 1 - PAPER TOWEL DISPENSER
- 1 - WASTE RECEPTACLE
- 1 - SOAP DISPENSER
- 1 - CHILD HANDWASHING SINK
- 1 - 24"X24" MIRROR
- 1 - URINAL SCREEN.

ADDITIONAL REQUIREMENTS:

- PROVIDE 5'-0" HALF HEIGHT, SIX INCH STUD WALLS TO ENSURE A BALANCE OF SUPERVISION AND PRIVACY (PROVIDE DURABLE WALL CAP, PROVIDE VERT. TUBE STEEL W/ BASEPLATE AT UNSECURED WALL ENDS)
- PROVIDE SMOOTH, HARD AND NON-ABSORBANT WALL MATERIAL TO A MIN. HT OF 4 FT. ABOVE FINISH FLOOR
- TOILET ROOM FLOORS MUST BE SMOOTH, HARD AND NON-ABSORBANT AND SHALL HAVE A SMOOTH, HARD AND NON-ABSORBANT VERTICAL BASE THAT EXTENDS UP THE WALL A MIN. OF 4 INCHES.
- PROVIDE ACCESSORIES AS SHOWN

\*\*COORDINATE NEW VTR LOCATION (PREFERRED LOCATION AWAY FROM ROOF EAVE TO AVOID DAMAGE FROM SEASONAL SNOW / ICE) 4'-0"

NEW HOSE BIB

CONSIDER AND LOCATE NEW  
FLOOR ACCESS DOOR WITH  
PERMANANT ACCESS STAIR.  
COORDINATE WITH  
FLOORING INSTALLATION